

Bernini Project 48V

BERNINI FANS

Faro luce spot orientabile per sistema a binario in termoplastica con finitura in bianco o nero opaco. Adjustable spot light in thermoplastic and aluminum track system with matt white or black finish.

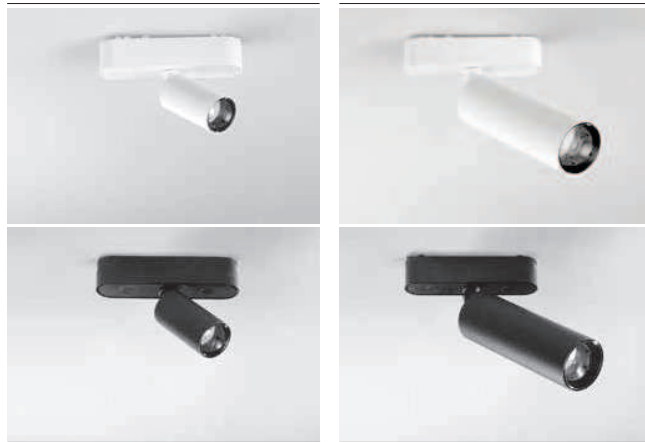
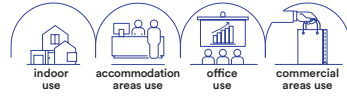

Materiale
alluminio e termoplastica

Colore
bianco opaco
nero opaco



Temperatura colore
3000K / 4000K



Driver
DC48V non incluso

Material
aluminum and thermoplastic

Colour
matt white
matt black



Colour temperature
3000K / 4000K



Driver
DC48V not included

	colour temp.	colour
BERNINI-FANS-5-BCO 8031414919994 lumen		
	550 lm	
BERNINI-FANS-5 8031414907496 lumen		
	550 lm	

watt	5W
beam angle	24°



	colour temp.	colour
BERNINI-FANS-15-BCO 8031414919680 lumen		
	1750 lm	
BERNINI-FANS-15 8031414907489 lumen		
	1750 lm	

watt	15W
beam angle	30°

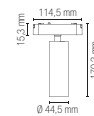

Fotometria del prodotto /
Photometric curve

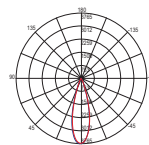

BERNINI-FANS-5

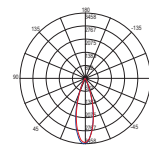

BERNINI-FANS-15



Bernini Project 48V

BERNINI TUBO

Lampada sospensione LED per sistema binario in termoplastica e alluminio con finitura in nero opaco. LED suspension lamp in aluminum and thermoplastic rail system with matt black finish.

Materiale
alluminio e termoplastica

Colore
bianco opaco
nero opaco



Temperatura colore
3000K / 4000K



Driver
DC48V non incluso

Material
aluminum and thermoplastic

Colour
matt white
matt black



Colour temperature
3000K / 4000K



Driver
DC48V not included



	colour temp.	colour
BERNINI-S10-BCO 8031414920112 lumen		
	1100 lm	
BERNINI-S10 8031414907540 lumen		
	1100 lm	

watt	9W
beam angle	24°

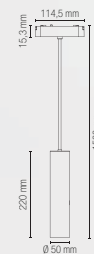

Fotometria del prodotto /
Photometric curve

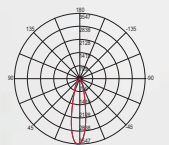

BERNINI-S10

In.tec light SISTEMA BINARI / TRACK LIGHTS